



86 East Avenue Beverley SA

3 1 9

Anthony Fonovic & Tim Morris Real Estate are proud to present this ideally located 3-bedroom home in the highly sought-after suburb of Beverley less than 5km to the city & 6km to the beach.

Brimming with every period detail including the stunning ornate high ceilings, it's easy to get excited about securing this solid brick bungalow with polished timber floors, 3 generous size bedrooms with quality plush carpet, massive 6 car garage & a large back yard offering invaluable scope to extend (STC).

At the top of the ornate entrance hall gleaming with polished timber floors you'll find the open plan kitchen, dining & lounge room. The kitchen boasts quality timber cabinetry with ample storage & electric cooking. As a bonus feature, the original stove remains in place & in

Price : \$ 720,000
Building Size : 125 sqm
Land Size : 790 sqm
View : <https://www.timmorris.com.au/6489660>



Anthony Fonovic
08 7225 2525



Tim Morris
08 7225 2525

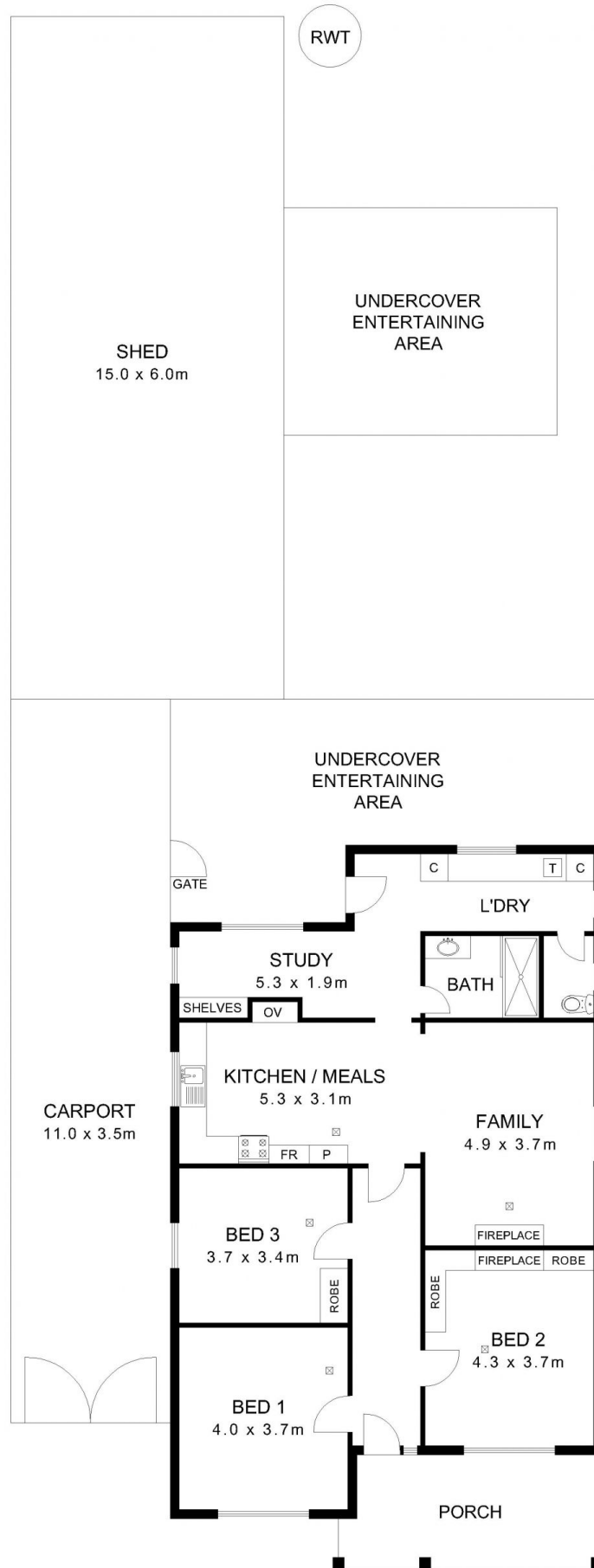

86 EAST AVENUE BEVERLEY

NOTE: While every effort has been made to verify the correct details in this brochure, neither the vendor, illustrator or agent accept liability for any error or omission. All parties are requested to take relevant action to satisfy themselves of any issues.

@ Copyright 2021 MAYMEDIA"