



## 9 Cunningham Lane Lightsview SA

2  1  1 

Chic, industrial-style, tri-level home, perfectly positioned, only 8km from the CBD, and close to local transport: from the moment you enter this stunning home you are greeted with style and spacious open plan living at its best.

Lower level offering a work from home office space, or second living area, serviced by separate lavatory, and galley-style laundry at the rear of the oversized garage with electric roller door.

The second level provides a chef's kitchen equipped with huge manufactured stone breakfast bar, gas cooker, dishwasher, large refrigerator cavity and convenient laundry chute, overlooking an ample balcony with fresh, flowing ventilation. The open plan lounge dining area is flooded with natural light, enticing entertaining with ease

**View :** <https://www.timmorris.com.au/7712706>



**Tony Press**  
0420561600



**Tim Morris**  
08 7225 2525



SECOND FLOOR

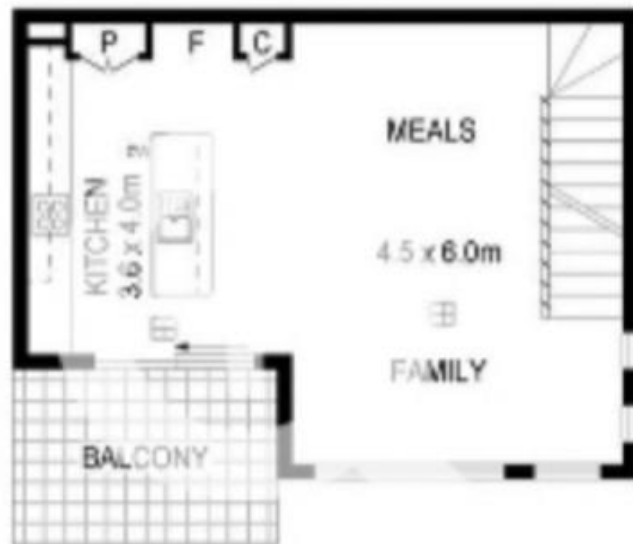

FIRST FLOOR



GROUND FLOOR

Area